



# ISHOWER001

## Rechargeable Camp Shower Owner's Manual



**IMPORTANT:** Please read all procedures and precautions before using the Ironman 4x4 Camp Shower. If you have any questions please contact our customer service department.

# Features

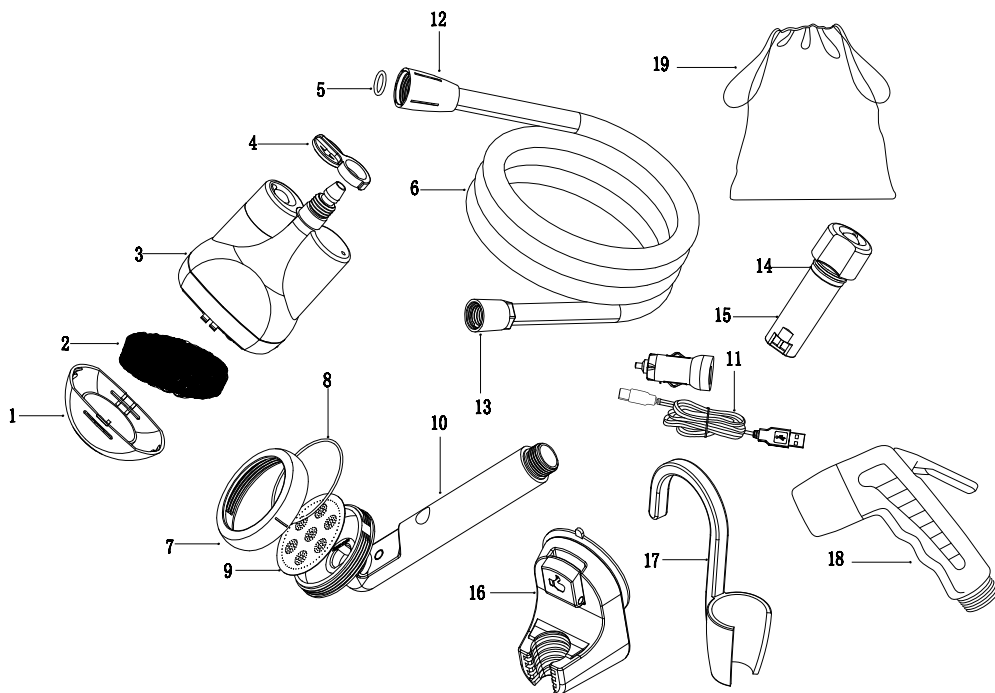

1. Filter cover
2. Filter net
3. Pump
4. Switch cover
5. O-ring
6. Hose
7. Fixing ring
8. O-ring
9. Stainless steel outlet sheet
10. Shower handle

11. USB Cable and Adaptor
12. Shower Head Connector
13. Pump Connector
14. O-ring for battery pack
15. Battery pack
16. Suction Holder
17. Hook
18. Shower Spray
19. Bag



# Assembly

## IMPORTANT SAFETY INSTRUCTIONS

- Please read instructions before using the unit.
- Operate only with water within the temperate range from 10°C to 50°C.
- Do NOT allow children to use the appliance unless under supervision of an adult.
- Do NOT use the shower while battery is charging.

## WARNING

- Do not leave appliance unattended when in use. Switch the unit off and remove from water when not in use.
- Fully charge the battery before first use.
- Do not use the shower with any liquid other than water.
- Ensure that the base of the pump is fully submerged in water.
- Recharge the pump only by DC power output: 5V, 0.5-2A only.
- Do not use damaged power cord or plug and charge only with correct voltage as listed. Using improper output voltage may result in damage to the pump motor and may cause possible injury to the user.
- Before use, ensure that there are no broken or worn parts.
- Keep the shower away from open fire.
- Do not attempt to disassemble your unit. This will void all warranties.

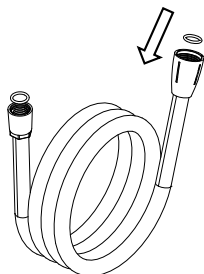

Insert O-ring (5) into shower head connector (12).

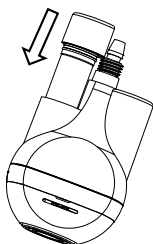

Install battery pack to pump.

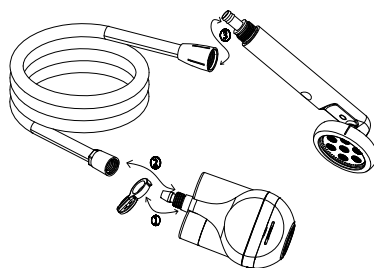

Attach switch cover & shower head hose to the pump.

# Operation Instructions

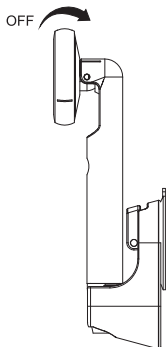

- ❶ Make sure the shower head is at “OFF” position.

Position shower head using the shower head bracket and hook or suction cup.

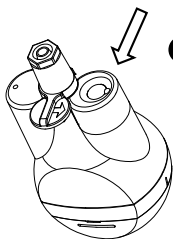
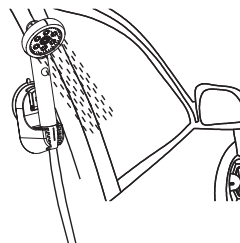

- ❷ Rotate Switch cover anti clock wise to expose switch. Press once quickly and switch will flash Blue 1 to 4 times to indicate 25% to 100% battery condition.

If the LED continues to flash this indicates that the battery condition is less than 25%.

Press for 3 seconds, switch will illuminate solid Blue and pump will start operating.

- ❸ Put pump into water

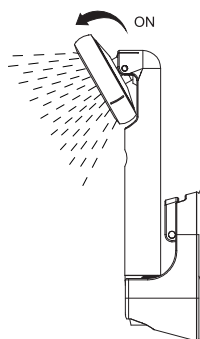
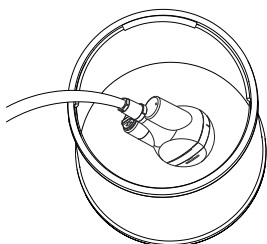

- ❹ Push the shower head down to start the water flow.

Push the shower head up to stop

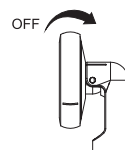

## IMPORTANT

- Switch off the pump before removing it from water.
- Pump will still run when the shower head is turned off. Don't leave the shower head switch in the off position for more than 5 minutes as it will affect the life of the pump.
- Ensure the shower head is securely mounted before use.



# Recharging

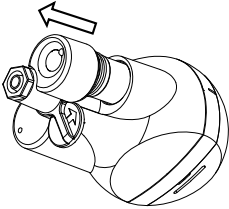

- ❶ Rotate switch cover to allow battery pack to be removed (Image of cover and battery being removed).

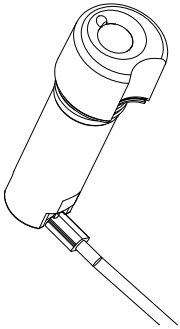

- ❷ Insert USB charging cable into charging socket. Use the following USB charging options:



- DC 12V car adaptor  
[2.5h - approx. charging time]

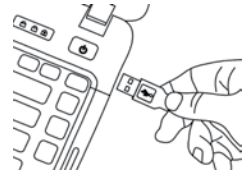

- Laptop with USB port  
[4.5h - approx. charging time]

When charging from a Vehicle if USB power is not available use the 5V Cigarette Lighter Adapter supplied

- ❸ Charging will be indicated by the Blue power button oscillating and solid when fully charged.

- ❹ Disconnect USB cable and reinstall to pump - Insert Image.

## IMPORTANT

The shower will stop automatically when the battery voltage is lower than 2.7V to protect the battery.

**Note: Please do not restart the unit. Fully charge the shower before next use.**

1. Fully charge the battery after each use.
2. Recharge the battery at least every three months to ensure it remains in a fully charged state.

# Maintenance

## IMPORTANT

- Ensure that the shower is dry and clean before storing into carry bag.
- Store the pump away from high temperature, freezing, flammable and explosive items.

**Clean or replace the filter net on bottom of pump or outlet plate on shower head if needed.**

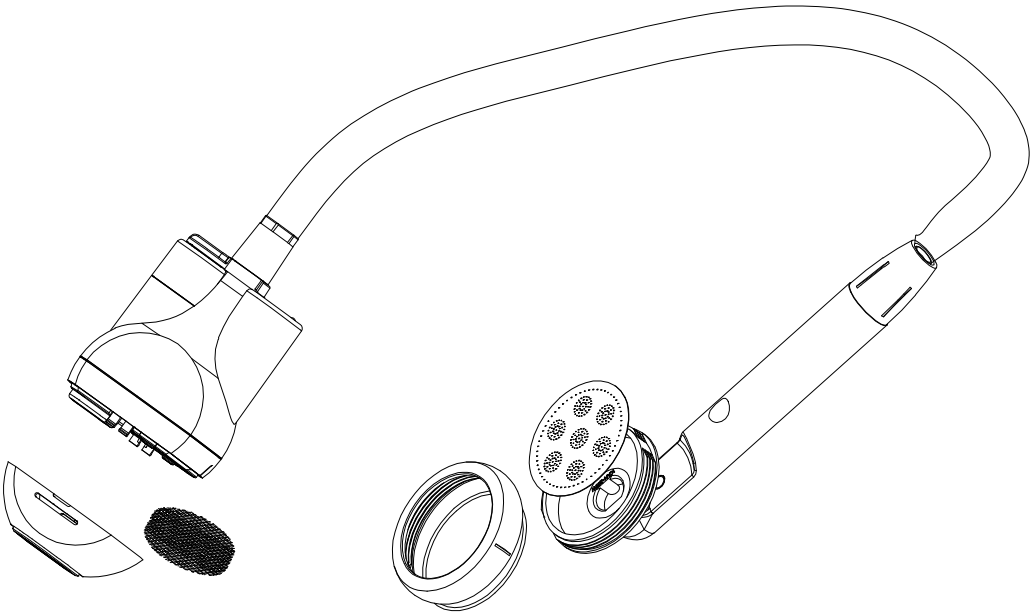



# Technical Details

CONSTRUCTION	
Case Material	ABS
Shower Head Material	ABS
Hose Material	PVC
Hose Length	2mtr
Approvals	CE, ROHS, PAHS, IPX8

ELECTRICAL	
Battery	3.7V 2200mAh Lithium Ion
Run Time	45 to 60 Minutes @ 100% capacity
Charge Time	4.5Hrs Max (approx)
Charge Cable	USB - 300mm length
Cigarette Lighter Adaptor	Output - 5V @ 2A

PERFORMANCE SPECIFICATIONS	
Max Water Temperature Allowed	50 °C
Flow Rate - Shower Head	3.0 Ltrs per Min
Flow Rate - Trigger Spray	2.5 Ltrs per Min





(SHOWR001/090621